

ANNEXURE C1

Lot 21 DP 1052637

IMPORTANT NOTICE REGARDING SERVICE DETAILS

1. VISUAL EVIDENCE IS SHOWN TO SURVEY ACCURACY.
2. INVERTS AND DIAMETERS ARE SHOWN WHERE REASONABLE ACCESS WAS OBTAINED.
3. DIRECTION OF SERVICES SHOWN HAVE BEEN DERIVED FROM VISUAL EVIDENCE OR SERVICE AUTHORITY DRAWINGS.
4. SERVICE DETAILS MUST BE CONFIRMED WITH THE RELEVANT SERVICE AUTHORITIES. THE PRESENCE OF SERVICES IS SHOWN BY AN INDICATIVE LINE WHICH DOES NOT IN ANY WAY REPRESENT THE NUMBER OR NATURE OF PIPES, CONDUITS ETC THAT MAY BE PART OF THE SERVICE
5. NO EXCAVATION, POT-HOLING, PROBING OR ELECTRONIC PICKUP HAS BEEN UNDERTAKEN UNLESS SPECIFICALLY NOTED ON THE PLAN

DIAL 1100 FOR DIAL BEFORE YOU DIG SERVICE
www.1100.com.au

ALL AREAS & DIMENSIONS
ARE APPROXIMATE
& SUBJECT TO FINAL SURVEY

"THIS DETAIL SURVEY IS NOT A "SURVEY" AS DEFINED BY THE SURVEYING AND SPATIAL INFORMATION ORS ACT, 2002. IF ANY CONSTRUCTION IS PLANNED IT WOULD BE ADVISABLE TO CARRY OUT FURTHER SURVEY WORK TO DETERMINE THE BOUNDARY DIMENSIONS. WHERE STREET WIDTH INFORMATION IS SHOWN IT IS SOURCED FROM MOST RECENT REGISTERED PLANS. NO MEASURED CHECKS HAVE BEEN MADE UNLESS SHOWN."

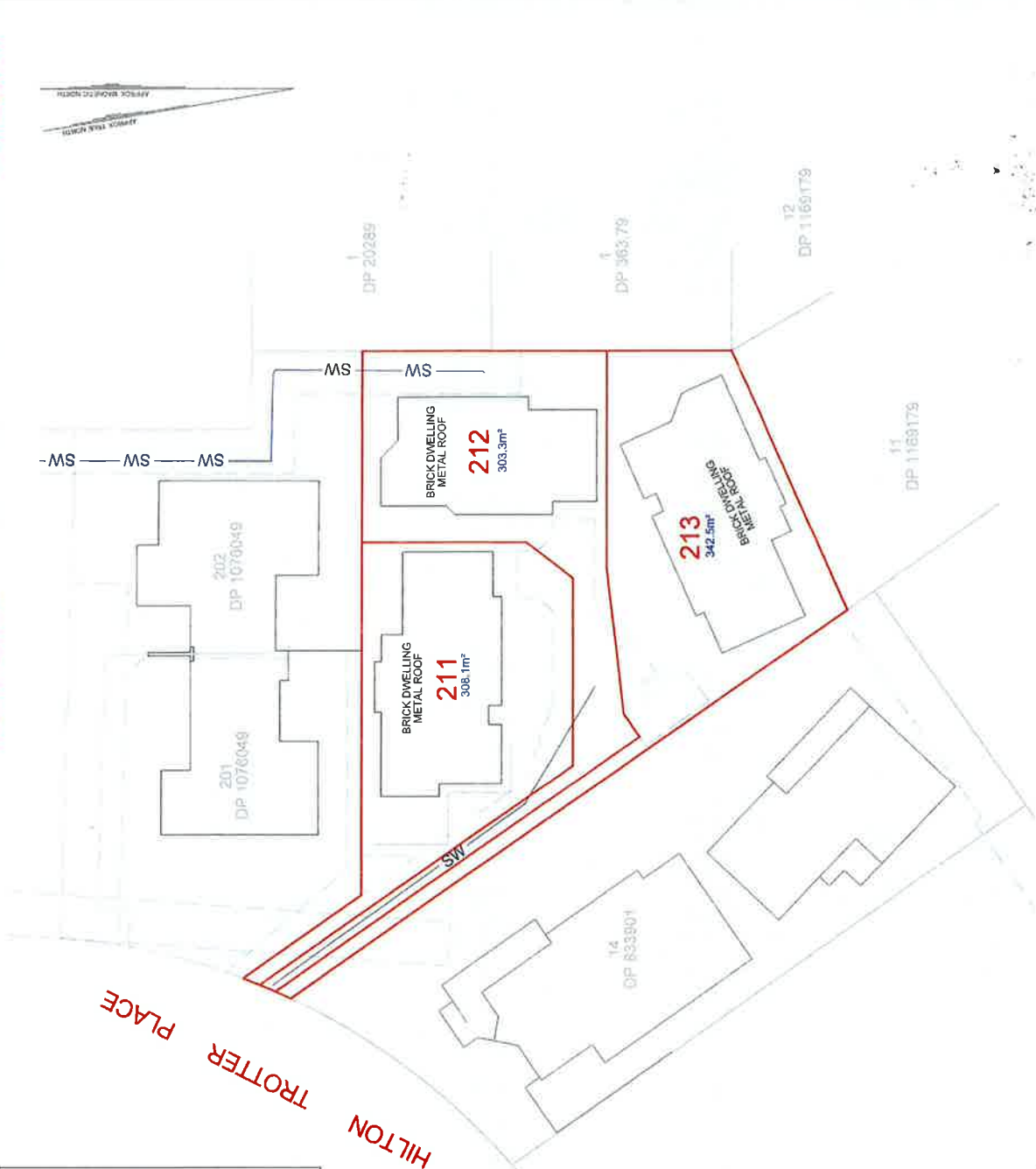

M.W. ROGERS & ASSOCIATES
URBAN & RURAL SUBDIVISION PLANNING & DEVELOPMENT
MARN 107 732 388
34/27 Elbow Street, B.O. Box 3074, West Kempsey NSW 2460
Phone (02) 6562-8888 Fax (02) 6562-4578
Email mail.mw@rogers.net.au

PLAN PURPOSE & AMENDMENTS

No.	DATE	REVISION
1	18/11/16	DA SUBDIVISION REFINED LAYOUT

PLAN OF
LOT 21 DP 1052637
HILTON TROTTER PLACE
WEST KEMPSEY
For: HAYES

L.G.A. KEMPSEY
SCALE: 1:300 (A3)
DATUM: AHD
DATE: 13/07/2016
APPROVED:
JOB No.: 16053DA01 VCD
SHEET 1 OF 2

APPENDIX A

ANNEXURE CII

LOT 21 DP 1052637



- (A) DP 1052637 - EASEMENT TO DRAIN WATER 3 WIDE
- (B) DP 833901 - EASEMENT TO DRAIN SEWAGE 3 WIDE & VARIABLE
- (C) RIGHT OF ACCESS & EASEMENT SERVICES VARIABLE
- (D) EASEMENT FOR PARKING

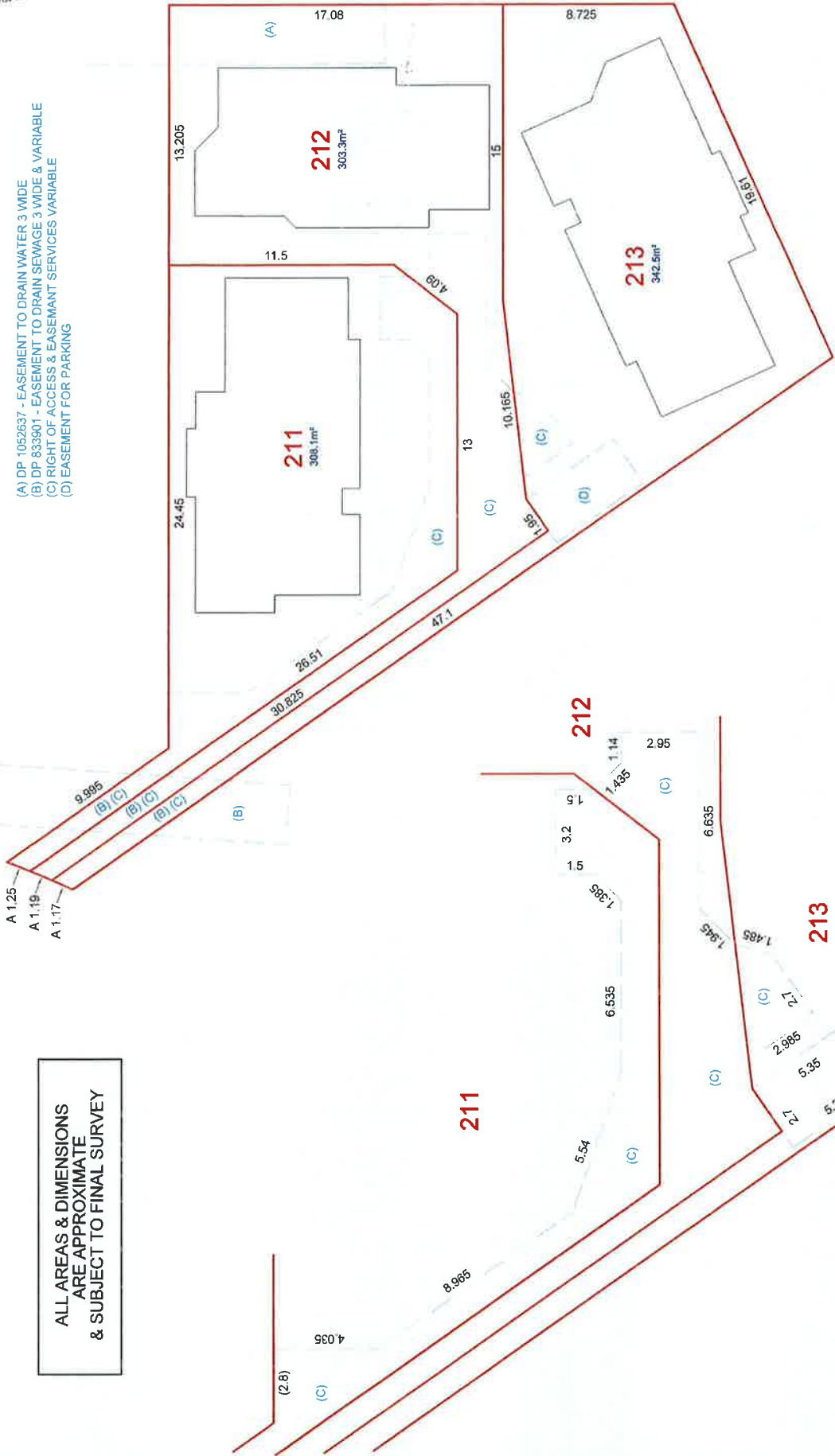

ALL AREAS & DIMENSIONS
ARE APPROXIMATE
& SUBJECT TO FINAL SURVEY

M.W. ROGERS & ASSOCIATES
 URBAN & RURAL SUBDIVISION PLANNING & DEVELOPMENT
 MARK ROGERS 8 Surv. Registered Surveyor, MS 1601
 8675 Elbow Street, P.O. Box 9375, West Kempsey 2440
 Phone (02) 65256688 Fax (02) 65254578
 Email mark.mw@bigpond.net.au

L.G.A. KEMPSEY
 SCALE: 1:200 (A3)
 DATUM: AHD
 DATE: 13/07/2016
 APPROVED:
 JOB No.: 16053DA01.VCD
 SHEET 2 OF 2

PLAN PURPOSE & AMENDMENTS	No.	DATE	REVISION
PLAN OF LOT 21 DP 1052637 HILTON TROTTER PLACE WEST KEMPSEY For: HAYES	1	19/11/16	DA SUBDIVISION REFINED LAYOUT